

DO NOT SCALE DRAWING - IF IN DOUBT ASK

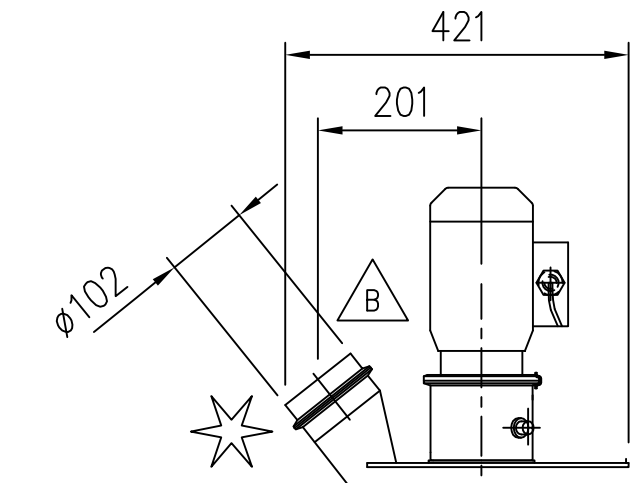

OPTION SHOWING INFEED REPLACED WITH TRICLOVER WELD FERRULE

SPEED CONTROL PICKUP

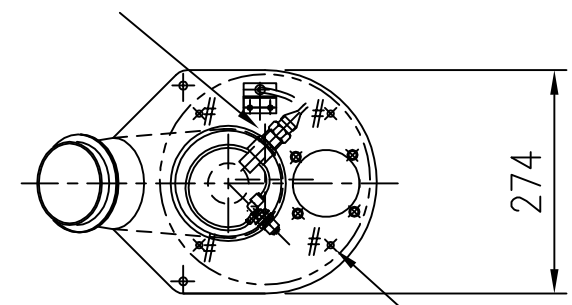

Q. MOTOR

4 HOLES HIGHLIGHTED THUS; '#' ARE FOR MOTOR SHROUD

NOTE

SAFETY INTERLOCKS MUST BE WIRED INTO MOTOR CONTROL CIRCUIT (BY CLIENT) TO PREVENT THE MOTOR RUNNING, OR DE-ENERGISE MOTOR IF ALREADY RUNNING, SHOULD THE INTERLOCK BE ACTUATED BY OPENING OF THE INSPECTION DOOR OR OVERSIZE END

MOTOR IP.55 ALUM.
0.55KW 3Ph-50Hz-220/415v or
0.75HP 3Ph-60Hz-230/460v

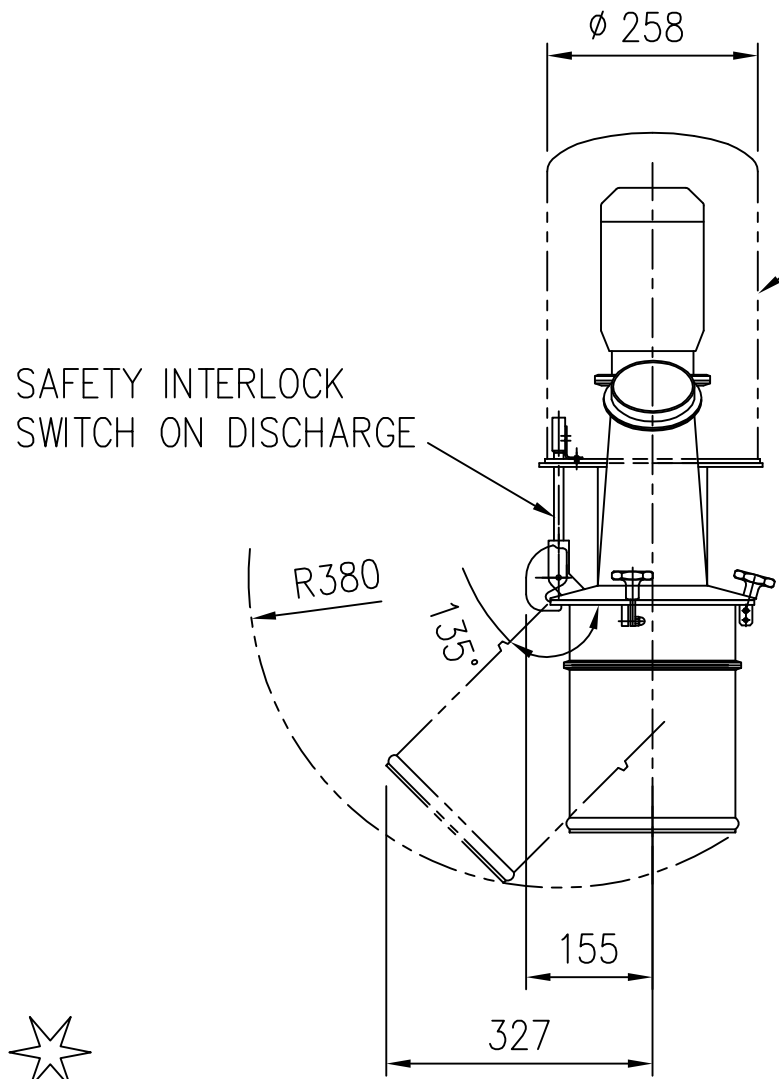

SAFETY INTERLOCK SWITCH ON DISCHARGE

OPTIONAL MOTOR SHROUD

INFEED HOPPER WITH SAFETY GRILLE

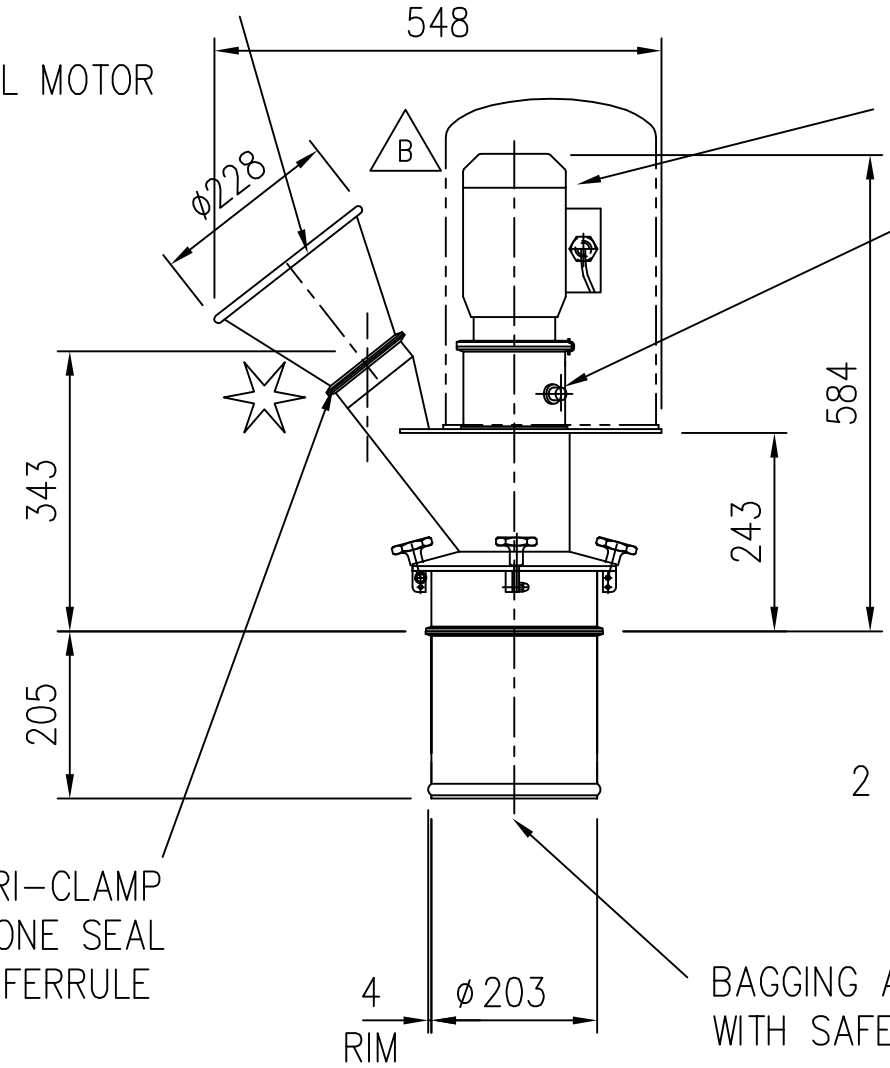

4" TRI-CLAMP SILICONE SEAL AND FERRULE

BAGGING ADAPTOR WITH SAFETY GRILLE

Ø6 BULKHEAD CONNECTOR FOR AIR PURGE

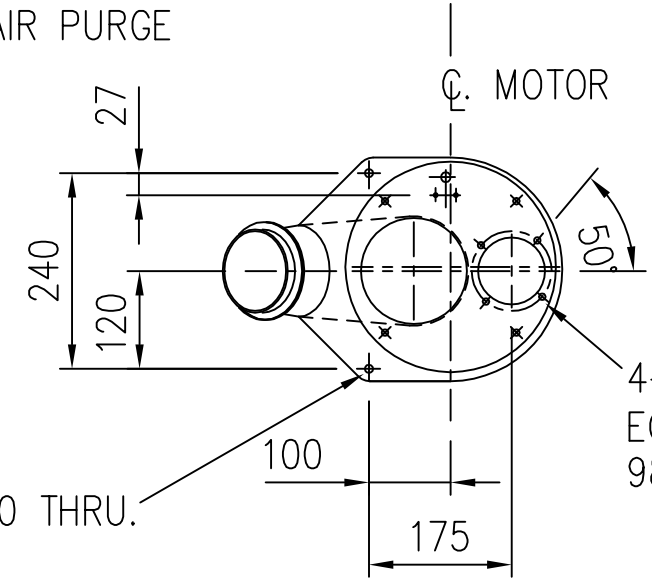

DETAILS OF MOUNTING HOLES

INLET CONNECTIONS MUST BE SUITABLY GUARDED BY CLIENT TO PREVENT OPERATOR ACCESS TO ROTATING/MOVING PARTS IN LINE WITH RELEVANT SAFETY REGULATIONS (SEE BS EN 294/BS5304:1988).

Kek-Gardner
Powder Processing Excellence
Kek-Gardner Ltd
Springwood Way, Macclesfield, Cheshire, SK10 2ND
Tel: +44 (0)1625 412000 Fax: +44(0)1625 412002
Email: sales@kekgardner.co.uk Web: www.kekgardner.com

| | |
|-------------|------------|
| DRAWN BY | D.F. DIXON |
| CHECKED BY | |
| APPROVED BY | |
| SCALE | 1:10 |
| DATE | 05/03/93 |

| |
|---|
| ISSUE B |
| OPTION SHOWING INFEED HOPPER/WELD FERRULE ADDED |
| NAME: M.R. DATE: 22.11.95 |

| | |
|------------|---------------|
| TITLE | 120 CONE MILL |
| DRAWING No | A3 DS 349 |
| ISSUE | B |

THIS DRAWING IS THE PROPERTY OF KEK-GARDNER LTD AND MUST NOT BE COPIED OR SHOWN TO A THIRD PARTY WITHOUT THE WRITTEN CONSENT OF THIS COMPANY. ©
NOT PLOTTED

| DRAWING SPECIFICATIONS |
|---|
| UNLESS OTHERWISE STATED |
| Screw threads to BS3643 |
| ISO Metric Coarse Pitch Series (Medium Fit) |
| Surface Finish to BS1134 in micrometres |
| Welding Symbols to BS499 Part 2 |
| Dimension & Geometrical Tolerances to BS308 |
| Limits & Fits to BS4500 |
| Remove all sharp edges and burrs |

| TOLERANCE SPECIFICATIONS | |
|--------------------------|-----------------------|
| UNLESS OTHERWISE STATED | |
| SHEET METAL DIMENSIONS | MACHINED DIMENSIONS |
| 0 to 300 ± 1.00 | 0 to 150 ± 0.30 |
| 300 to 1000 ± 2.00 | Over 150 ± 0.60 |
| Over 1000 ± 3.00 | |
| ANGULAR DIMENSIONS | UNMACHINED DIMENSIONS |
| ± 0°-30' | 0 to 150 ± 0.50 |
| | Over 150 ± 1.50 |

| ALL DIMENSIONS IN MILLIMETRES |
|--|
| THIRD ANGLE PROJECTION |
| For all material, weld and finish specifications refer to purchase/works order unless stated otherwise |